

## Dual-Row



### Two Rows per Tracker

Agile™-1P is a dual-row tracker with one primary slewing drive in one row and one secondary slewing drive in another row. Two slewing drives share one motor and one TCU.



### Innovative SuperTrack Technology

According to real-time weather and actual terrain conditions, smart algorithm dynamically optimizes tracking angle, increases receiving radiation and reduces shading loss.

Up to **8%** yield gain



### More Modules per Tracker

Compatible with modules up to **670W+**



### Designed for Challenging Conditions

The Agile™-1P has been designed for sites that have both challenging terrain and high wind conditions

Up to **20%** N-S slope.



### Higher Reliability

The two slewing drives in Agile™-1P are connected by a transmission bar with a cardan design that improves the transmission efficiency, also has an optimized stow position and alarm strategy for a safer and more robust structure.

### TRINA CLAMP

Trina Clamp is a proprietary product that is quick and easy to use with the 1P configuration, reducing the installation time and costs.

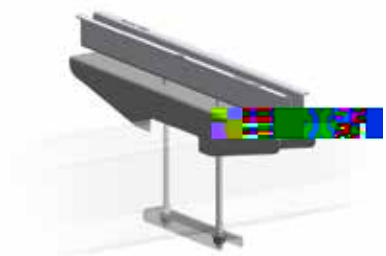

### WIND TUNNEL TESTED BY CPP

Detailed wind tunnel test methodology to reproduce the most realistic tracker behavior and analyze the aerolastic effects that impact tracker structures.

